



LOCATION MAP

PROJECT LOCATION



*CITY OF BROOKHAVEN
DEPARTMENT OF PUBLIC WORKS
CONSTRUCTION PLANS
FOR
BRIARWOOD RD. MULTI-USE PATH
PROJECT
BUFORD HIGHWAY TO
PEACHTREE CREEK GREENWAY*

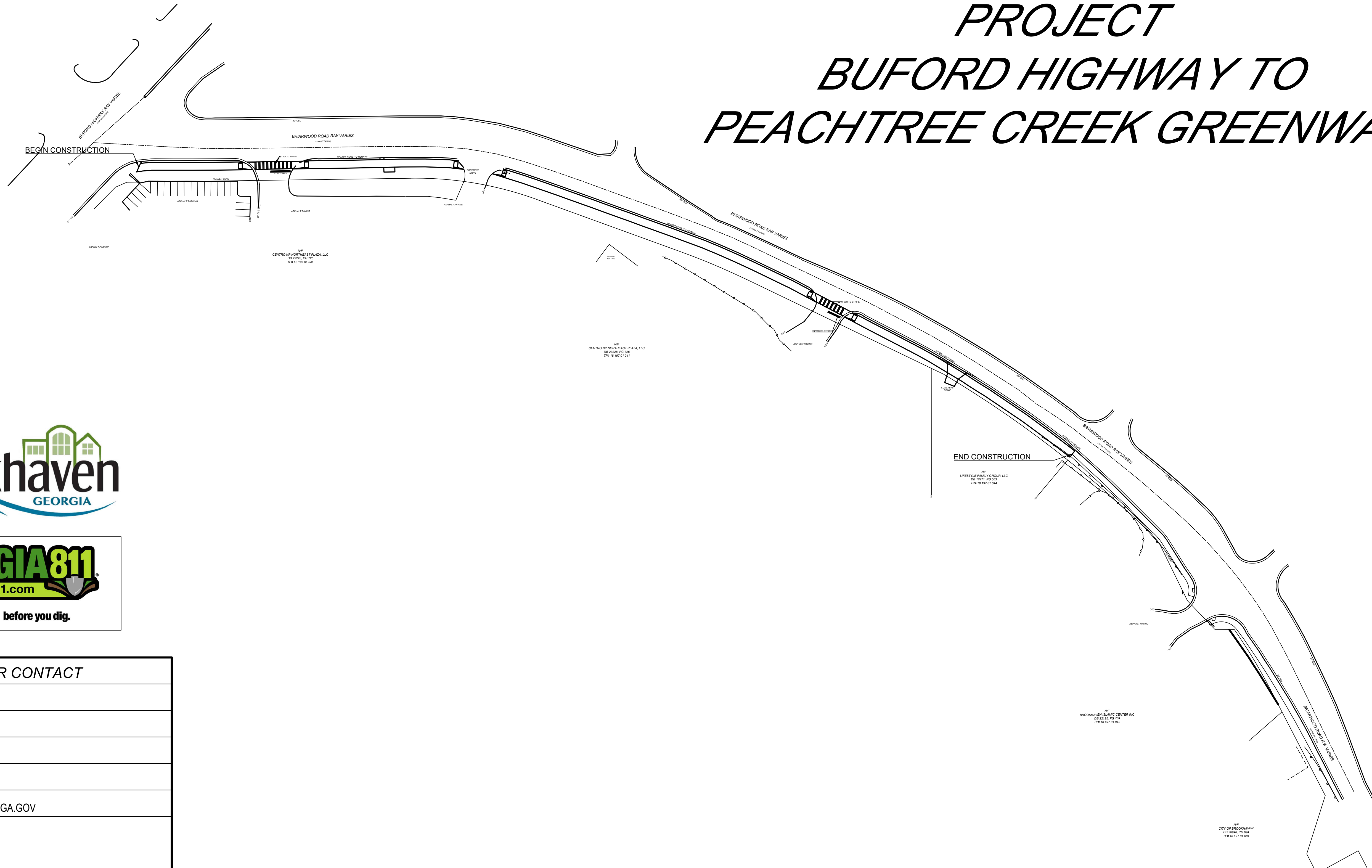

Contact 811 before you dig.

24 HOUR CONTACT

DON SHERRILL, PE, PLS
NAME
4362 PEACHTREE ROAD
STREET ADDRESS
BROOKHAVEN, GA 30319
CITY, STATE ZIP
404-991-4763
PHONE NUMBER
DON.SHERRILL@BROOKHAVENGA.GOV
EMAIL ADDRESS

CITY OF BROOKHAVEN
PUBLIC WORKS DEPARTMENT

Project No.	No.	Revision	Date
	#1		
	#2		
	#3		
	#4		
	#5		
	#6		
	#7		
	#8		
	#9		
	#10		
	#11		
	#12		
	#13		
	#14		
	#15		
	#16		
	#17		
	#18		
	#19		
	#20		
	#21		
	#22		
	#23		
	#24		
	#25		
	#26		
	#27		
	#28		
	#29		
	#30		
	#31		
	#32		
	#33		
	#34		
	#35		
	#36		
	#37		
	#38		
	#39		
	#40		
	#41		
	#42		
	#43		
	#44		
	#45		
	#46		
	#47		
	#48		
	#49		
	#50		
	#51		
	#52		
	#53		
	#54		
	#55		
	#56		
	#57		
	#58		
	#59		
	#60		
	#61		
	#62		
	#63		
	#64		
	#65		
	#66		
	#67		
	#68		
	#69		
	#70		
	#71		
	#72		
	#73		
	#74		
	#75		
	#76		
	#77		
	#78		
	#79		
	#80		
	#81		
	#82		
	#83		
	#84		
	#85		
	#86		
	#87		
	#88		
	#89		
	#90		
	#91		
	#92		
	#93		
	#94		
	#95		
	#96		
	#97		
	#98		
	#99		
	#100		

CONSTRUCTION PLANS
FOR
BRIARWOOD ROAD MULTIUSE PATH PROJECT
BUFORD HWY TO PEACHTREE CREEK GREENWAY
LOCATED IN
LAND LOT 197, 18TH DISTRICT
CITY OF BROOKHAVEN, DEKALB COUNTY, GEORGIA

SHEET NO.
1
10

GENERAL NOTES

- ALL WORK SHALL BE DONE IN ACCORDANCE WITH THE GEORGIA DEPARTMENT OF TRANSPORTATION STANDARD AND SUPPLEMENTAL SPECIFICATIONS, CURRENT EDITION AND/OR CITY OF BROOKHAVEN SPECIFICATIONS AND DETAILS.
- A NOTICE OF INTENT IS NOT REQUIRED ON THIS PROJECT. THIS PROJECT HAS A TOTAL AREA OF 0.12 ACRES AND THE EXPECTED DISTURBED AREA IS 0.12 ACRES. THE TOTAL AREA IS THE AREA OF RIGHT-OF-WAY AND EASEMENTS, AND THE DISTURBED AREA IS THE CLEARING AND GRUBBING AREA.
- ALL KNOWN UTILITY FACILITIES ARE SHOWN SCHEMATICALLY ON THE PLANS AND ARE NOT NECESSARILY ACCURATE IN LOCATION AS TO PLAN OR ELEVATION. UTILITY FACILITIES SUCH AS SERVICE LINES OR UNKNOWN FACILITIES NOT SHOWN ON PLANS WILL NOT RELIEVE THE CONTRACTOR OF HIS RESPONSIBILITY UNDER THIS REQUIREMENT. 'EXISTING UTILITY FACILITIES' MEANS ANY UTILITY THAT EXISTS ON THE PROJECT IN ITS ORIGINAL, RELOCATED, OR NEWLY INSTALLED POSITION. ALL UTILITY FACILITIES, WHICH ARE IN CONFLICT WITH CONSTRUCTION AND ARE NOT COVERED AS SPECIFIC ITEMS IN THE DETAILED ESTIMATE, ARE TO BE REMOVED OR RELOCATED TO CLEAR CONSTRUCTION IN ADVANCE OF THIS WORK.
- UTILITY WORK COORDINATION WILL BE REQUIRED AS PART OF THIS CONTRACT. THE CONTRACTOR WILL BE REQUIRED TO USE THE ON-CALL CENTER TELEPHONE NUMBER, 811 OR 1-800-282-7411, FOR THE PURPOSE OF COORDINATING THE MARKING OF UNDERGROUND UTILITIES. THE CONTRACTOR'S ATTENTION IS CALLED TO SUB-SECTION 105.06 OF THE GADOT STANDARDS SPECIFICATIONS 'COOPERATION WITH UTILITIES.'
- THE FOLLOWING UTILITIES MAY HAVE FACILITIES IN THE PROJECT AREA:
 - ATLANTA GAS LIGHT CO.
 - GEORGIA POWER
 - ATT
 - GOOGLE FIBER
 - COMCAST COMMUNICATIONS
 - ZAYO FIBER
 - DEKALB COUNTY WATER & SEWER
- THE CONTRACTOR SHALL STRICTLY ADHERE TO DUST CONTROL REGULATIONS. ALL AREAS SUBJECT TO DUST FORMATION MUST BE PERIODICALLY WATERED. ALL COSTS FOR DUST CONTROL SHALL BE INCLUDED IN PRICE BID FOR ENTIRE PROJECT-LUMP SUM.
- THE TOTAL AREA SHOWN ON THE PLANS FOR GRASSING IS FOR INFORMATION ONLY. THE CITY OF BROOKHAVEN ASSUMES NO RESPONSIBILITY FOR ITS ACCURACY. THE CONTRACTOR SHALL BID ON GRASSING COMPLETE LUMP SUM AND IT SHALL BE HIS RESPONSIBILITY TO DETERMINE THE ACTUAL AREA TO BE GRASSED. NO CLAIMS WILL BE CONSIDERED FOR COMPENSATION IF THE CONTRACTOR RELIES ON THE AREA SHOWN ON THE PLANS.
- INGRESS AND EGRESS SHALL BE MAINTAINED AT ALL TIMES TO ADJACENT PROPERTIES. REFER TO SUB-SECTION 107.07 OF THE GADOT STANDARD SPECIFICATIONS.
- IT SHALL BE THE CONTRACTOR'S RESPONSIBILITY TO FURNISH SUITABLE BORROW MATERIAL FOR THE PROJECT AND DISPOSE OF ANY UNSUITABLE OR WASTE MATERIAL.
- HORIZONTAL CONTROL IS BASED UPON GEORGIA STATE PLANE COORDINATE SYSTEM. SEE PLANS FOR LOCATIONS AND DESCRIPTIONS OF MONUMENTS USED.
- WHERE WET SUBGRADE IS ENCOUNTERED AND WHERE IDENTIFIED BY THE ENGINEER, UNDER DRAIN PIPE WITH DRAINAGE AGGREGATE SHALL BE PLACED AS DIRECTED BY THE ENGINEER TO AID IN DEWATERING THE SUBGRADE.
- AGGREGATE SURFACE COURSE FOR TEMPORARY DRIVEWAYS, INCLUDING MATERIAL, HAUL AND PLACEMENT SHALL BE USED AT THE ENGINEER'S DIRECTION TO FACILITATE THE MOVEMENT OF LOCAL TRAFFIC THROUGH THE CONSTRUCTION AREA DURING INCLEMENT WEATHER. WHEN USED FOR THIS PURPOSE, SECTION 318 OF THE GADOT STANDARDS SPECIFICATIONS IS MODIFIED TO PERMIT TRUCK DUMPING ON UNPREPARED WET, MUDDY SUBGRADE. SECTION 318 IS FURTHER MODIFIED TO PERMIT THE USE OF CRUSHER STONE AS DESCRIBED IN SECTION 318.02. THE CONTRACTOR WILL HAVE THE USE OF THE FOLLOWING MATERIALS:
 - GRADED AGGREGATE, ARTICLE 815.2.01
 - COURSE AGGREGATE, SIZE 467, ARTICLE 800.2.01
 - STABILIZED AGGREGATE, TYPE 1 OR 11, SECTION 803.2.61 OR 803.2.02
 - CRUSHED STONE, ARTICLE 806.2.01
- ALL DRIVEWAYS WHERE ACCESS IS ALLOWED SHALL BE PLACED AS DIRECTED BY THE ENGINEER IN ACCORDANCE WITH RULES AND REGULATIONS FOR CONTROL AND PROTECTION OF RIGHTS-OF-WAY. ALL DRIVEWAYS THAT ARE TO BE RECONSTRUCTED SHALL BE REPLACED IN KIND, I.E., ASPHALT FOR ASPHALT, CONCRETE FOR CONCRETE, AND CONCRETE FOR EARTH. THE DRIVEWAY LOCATION INDICATED ON THE PLANS IS TO MATCH THE ACTUAL FIELD LOCATION OF EXISTING DRIVEWAYS WHERE THEY ARE NOT IN CONFLICT WITH THE RULES AND REGULATIONS. THE CONTRACTOR SHALL OBTAIN THE APPROVAL OF THE ENGINEER PRIOR TO MAKING ANY REVISIONS SUCH AS LOCATION, WIDTH, AND/OR NUMBER OF DRIVES TO BE CONSTRUCTED. ASPHALTIC AND UNPAVED DRIVES SHALL BE PAVED TO THEIR CONSTRUCTION LIMITS. WHERE REQUIRED, THE DRIVES SHALL BE PAVED AS FOLLOWS:
 - RESIDENTIAL CONCRETE DRIVES:
 - 6" DRIVEWAY CONCRETE
 - 6" CONCRETE VALLEY GUTTER
 - RESIDENTIAL ASPHALT DRIVES:
 - 1-1/2" ASPH. CONC. 12.5 MM SUPERPAVE, 165 LB/SY
 - 6" GRADED AGGREGATE BASE
 - COMMERCIAL CONCRETE DRIVES:
 - 8" DRIVEWAY CONCRETE
 - 8" CONCRETE VALLEY GUTTER
 - COMMERCIAL ASPHALT DRIVES:
 - 1-1/2" ASPH. CONC. 12.5 MM SUPERPAVE, 165 LB/SY
 - 2" ASPH. CONC. 18 MM SUPERPAVE, 220 LB/SY
 - 6" GRADED AGGREGATE BASE
- THE CONTRACTOR SHALL OBSERVE ALL APPLICABLE LOCAL, STATE, AND FEDERAL SAFETY REGULATIONS REGARDING PIPE INSTALLATION IN TRENCHES. NO SEPARATE PAYMENT WILL BE MADE FOR ANY COST INCURRED TO COMPLY WITH THE REQUIREMENT.
- ALL EXISTING PIPE SHALL REMAIN UNLESS OTHERWISE NOTED ON PLANS OR AS DIRECTED BY THE ENGINEER. COST FOR REMOVAL SHALL BE INCLUDED IN THE PRICE BID FOR GRADING COMPLETE-LUMP SUM.
- AT LOCATIONS WHERE NEW PAVEMENT IS TO BE REPLACED ADJACENT TO EXISTING PAVEMENT WITHOUT AN OVERLAY OR WHERE CURBING IS TO BE PLACED ACROSS A PAVED AREA, A JOINT SHALL BE SAWED ON A LINE ESTABLISHED BY THE ENGINEER TO ENSURE PAVEMENT REMOVAL TO A NEAT LINE. THE COST FOR SAWED JOINTS, WHEN REQUIRED, SHALL BE INCLUDED IN PRICE BID FOR OTHER CONTRACT ITEMS, EXCEPT WHEN SAWING P.C.C. CONCRETE PAVEMENT.
- ALL AREAS WHERE THERE ARE EXISTING CATCH BASINS OR DRAINAGE INLETS WHERE THE SIDEWALK IS TO BE CONSTRUCTED, THE SIDEWALK SLOPE SHALL BE ADJUSTED TO TIE IN SMOOTHLY WITH THE EXISTING DRAINAGE STRUCTURES.
- WHERE EXISTING PAVEMENT MARKINGS AND LINES ARE IN CONFLICT WITH THE TRAFFIC PATTERN BEING USED ON CONSTRUCTION, THE CONTRACTOR SHALL REMOVE OR OVERLAY LINES TO THE SATISFACTION OF THE ENGINEER SUCH THAT THE LINES DO NOT CONFUSE THE TRAVELING PUBLIC. ALL REMAINING LINES OR MARKINGS SHALL BE IN ACCORDANCE WITH THE MANUAL ON UNIFORM TRAFFIC CONTROL DEVICES, LATEST EDITION, OR AS DIRECTED BY THE ENGINEER. TRAFFIC SHALL NOT BE ALLOWED ON ANY PAVEMENT NOT PROPERLY STRIPEED. WHEN NECESSARY, EXISTING STRIPING SHALL BE REMOVED BY GRINDING, UNLESS SPECIFIED BY THE BROOKHAVEN TRAFFIC ENGINEER.
- THE CONTRACTOR'S ATTENTION IS DIRECTED TO ARTICLES 104.05 AND 107.07 OF THE GADOT STANDARD SPECIFICATIONS AND THE SPECIAL PROVISIONS FOR TRAFFIC CONTROL AND SEQUENCE OF OPERATIONS IN REGARD TO MAINTENANCE OF TRAFFIC DURING CONSTRUCTION.
- PRICE BID FOR TRAFFIC CONTROL - LUMP SUM SHALL INCLUDE, BUT IS NOT LIMITED TO CONSTRUCTION, MAINTENANCE, AND REMOVAL OF TEMPORARY SIGNAGE AND PAVEMENT MARKINGS, BARRICADES, CHANNELIZING DEVICES, ETC. REQUIRED FOR MAINTENANCE OF TRAFFIC DURING CONSTRUCTION. ALL TEMPORARY SIGNING AND PAVEMENT MARKING SHALL BE IN ACCORDANCE WITH THE MANUAL OF UNIFORM TRAFFIC CONTROL DEVICES LATEST EDITION AND/OR AS DIRECTED BY THE ENGINEER. TEMPORARY TRAFFIC CONTROL AND WARNING DEVICES SHALL BE PLACED PRIOR TO THE COMMENCEMENT OF ANY ROAD IMPROVEMENT WORK ON CITY ROADS AND SHALL REMAIN IN PLACE UNTIL THE CONCLUSION OF ALL SIGNAGE AND STRIPING WORK. ALL FINAL SIGNAGE MUST BE INSTALLED CONCURRENTLY WITH THE PERFORMANCE OF THE STRIPING WORK.
- ALL ADA WHEELCHAIR RAMP WITHIN THE RADII SHALL BE 8 INCH CONCRETE.
- A NOTICE OF INTENT (NOI) IS NOT REQUIRED FOR THIS PROJECT. THE DISTURBED AREA IS 0.26 ACRE

- MAXIMUM SLOPE FOR CUT OR FILL IS 2H: 1V EXCEPT EARTHEN DAM EMBANKMENTS SHALL BE 3H: 1V.
- ALL CUT AND FILL SLOPES SHALL BE GRASSED AS DIRECTED BY THE ENGINEER IMMEDIATELY AFTER THE SLOPES ARE ESTABLISHED IN ORDER TO REDUCE EROSION. IF THE SEASON DOES NOT PERMIT GRASSING, TEMPORARY MULCH SHALL BE USED AS DIRECTED BY THE ENGINEER. REFER TO SECTION 161 OF THE STANDARD SPECIFICATIONS.
- THE CONTRACTOR SHALL ENSURE THAT POSITIVE AND ADEQUATE DRAINAGE IS MAINTAINED AT ALL TIMES WITHIN THE PROJECT LIMITS. THIS MAY INCLUDE, BUT NOT LIMITED TO, REPLACEMENT OR RECONSTRUCTION OF EXISTING DRAINAGE STRUCTURES THAT HAVE BEEN DAMAGED OR REMOVED OR REGRADING AS REQUIRED BY THE ENGINEER, EXCEPT FOR THOSE DRAINAGE ITEMS SHOWN AT SPECIFIC LOCATIONS IN THE PLANS AND HAVE SPECIFIC PAY ITEMS IN THE DETAILED ESTIMATE. NO SEPARATE PAYMENT WILL BE MADE FOR ANY COSTS INCURRED TO COMPLY WITH THIS REQUIREMENT.
- EROSION CONTROL MEASURES SHALL BE INSTALLED PRIOR TO OR CONCURRENT WITH LAND DISTURBANCE ACTIVITIES AND SHALL BE MAINTAINED AT ALL TIMES. ADDITIONAL EROSION AND SEDIMENT CONTROL DEVICES SHALL BE INSTALLED IF DEEMED NECESSARY BY ON-SITE INSPECTION OR AS DIRECTED BY THE ENGINEER.
- ALL SILT FENCES MUST BE PLACED AS ACCESS IS OBTAINED DURING CLEARING. NO GRADING SHALL BE DONE UNTIL SILT FENCE INSTALLATION IS COMPLETE. IT IS THE CONTRACTOR'S RESPONSIBILITY TO MAINTAIN ALL SILT FENCES AND TO REPAIR OR REPLACE ANY SILT FENCE THAT IS NOT SATISFACTORY. EROSION CONTROL CHECK DAMS OR FILTER RINGS SHALL BE PLACED IMMEDIATELY AFTER DRAINAGE STRUCTURES ARE IN PLACE. ALL EROSION CONTROL DEVICES SHALL BE PLACED ACCORDING TO THE PLANS AND AS DIRECTED BY THE ENGINEER. SEE THE GADOT STANDARD SPECIFICATIONS REGARDING EROSION CONTROL AND THE MANUAL FOR EROSION AND SEDIMENT CONTROL BY G.S.W.C.C. THE CONTRACTOR SHALL BE RESPONSIBLE FOR KEEPING WETLAND AREAS FREE FROM SILTATION. THE CONTRACTOR SHALL OBTAIN AND ABIDE BY ALL CORPUS OF ENGINEERS RULES AND REGULATIONS CONCERNING CONSTRUCTION ADJACENT TO WATER AREAS AND MAINTAIN WATER QUALITY.
- ALL BUFFERS AND TREE SAVE AREAS ARE TO BE CLEARLY IDENTIFIED WITH TREE PROTECTIVE FENCING PRIOR TO COMMENCEMENT OF ANY LAND DISTURBANCE.
- CONSTRUCTION LAYOUT WILL BE REQUIRED BY THE CONTRACTOR. ALL COST FOR THIS ITEM WILL BE INCLUDED IN THE PRICE BID FOR OTHER CONTRACT ITEMS.
- TYPE OF GRASS OR SOD USED ON THIS PROJECT WILL BE REQUIRED TO MATCH ANY TYPE OF GRASS OR SOD WHICH MAY BE PLANTED AND GROWING ON THE ADJACENT LAWN, I.E. BERMUDA SOD FOR BERMUDA SOD, ZOYSIA FOR ZOYSIA, ETC. NO SEPARATE PAYMENT WILL BE MADE FOR ANY COST INCURRED TO COMPLY WITH THIS REQUIREMENT.
- THE CONTRACTOR WILL BE RESPONSIBLE FOR PRE-MARKING ALL SIGNAGE, STRIPING, AND HANDICAP RAMPS. AFTER PRE-MARKING IS COMPLETE AND 72 HOURS IN ADVANCE OF INSTALLATION THE CONTRACTOR SHALL NOTIFY THE CITY OF BROOKHAVEN DEPARTMENT OF PUBLIC WORKS FOR APPROVAL. THIS SHALL BE COORDINATED WITH THE PROJECT ENGINEER.
- NO LANE CLOSURES ARE ALLOWED BETWEEN 6-9 AM AND 4-7 PM WITHOUT PRIOR APPROVAL BY THE CITY OF BROOKHAVEN.
- ALL SIGNS AND PAVEMENT MARKINGS SHALL CONFORM TO THE MANUAL ON UNIFORM TRAFFIC CONTROL DEVICES, (MUTCD), LATEST EDITION, AND ANY APPLICABLE GEORGIA DEPARTMENT OF TRANSPORTATION STANDARDS.
- ALL DEBRIS AND WASTE FROM THE PROJECT WILL BE DISPOSED OF PROPERLY BY THE CONTRACTOR.
- THE CONTRACTOR SHALL BE RESPONSIBLE FOR REPAIRING ANY DAMAGE TO EXISTING IRRIGATION SYSTEMS WHICH OCCURS AS A RESULT OF ANY WORK ASSOCIATED WITH THIS PROJECT.
- ANY PAY ITEM QUANTITIES IN THE CONTRACT THAT ARE GREATER THAN THE QUANTITIES NECESSARY TO CONSTRUCT THE PROJECT SHALL BE UTILIZED AS DIRECTED BY ENGINEER.
- CONTRACTOR TO ENSURE ALL STREET SIGNS THAT ARE TO BE REMOVED AND REPLACED ARE STORED SAFELY AND SECURELY AND REPLACED IN GOOD CONDITION.
- PRIOR TO COMMENCEMENT OF CONSTRUCTION ACTIVITY, CONTRACTOR SHALL SUBMIT A TRAFFIC CONTROL PLAN TO THE CITY OF BROOKHAVEN'S TRAFFIC ENGINEER FOR REVIEW AND APPROVAL. CONTRACTOR SHALL OBTAIN ALL REQUIRED PERMITS FROM THE CITY OF BROOKHAVEN FOR LANE CLOSURES OR WORK WITHIN THE CITY'S RIGHT-OF-WAY.

SIDEWALK CONSTRUCTION NOTES

- USE 3/8" X 10' EXPANSION JOINTS AT CHANGE OF DIRECTIONS, CURBS, RIGID STRUCTURES AND RIGID PAVEMENT. ON STRAIGHT RUNS PROVIDE EXPANSION JOINTS EVERY 25 FEET.
- TOOL ALL EXPOSED EDGES AND JOINTS TO 1/4" RADIUS
- BROOM FINISH PERPENDICULAR TO TRAVEL
- PROVIDE 3/4" DEEP SAW CUT CONTRACTION JOINTS EVERY 5' -0".
- MULTIUSE PATH TO BE 4" THICK EXCEPT WITHIN LIMITS OF RADIUS OF DRIVES WHERE IT IS TO BE 8".

SURVEY INFORMATION BASED ON A TOPOGRAPHIC SURVEY FOR THE CITY OF BROOKHAVEN, BRIARWOOD ROAD PREPARED BY EARTHPRO LAND SURVEYING COMPANY DATED AUGUST 12, 2019.

CITY OF BROOKHAVEN GENERAL TRANSPORTATION NOTES:

- ALL TRAFFIC CONTROL AND WARNING DEVICES MUST BE SHOWN AND PLACED PER MUTCD. THE CONTRACTOR IS TO SUBMIT A TRAFFIC CONTROL PLAN TO THE CITY TRAFFIC ENGINEER PRIOR TO COMMENCEMENT OF WORK.
- TEMPORARY TRAFFIC CONTROL AND WARNING DEVICES SHALL BE PLACED PRIOR TO COMMENCEMENT OF ANY ROAD IMPROVEMENT WORK ON CITY ROADS AND SHALL REMAIN IN PLACE UNTIL THE CONCLUSION OF ALL SIGNING AND STRIPING WORK.
- ALL SIGNS SHALL CONFORM TO MUTCD STANDARDS AND BROOKHAVEN COLOR, SIZE, REFLECTIVITY, HEIGHT, AND PLACEMENT.
- STRIPING (WHITE AND YELLOW) AND ARROW MARKING SHALL BE APPLIED USING GDOT STANDARDS FOR THERMOPLASTIC STRIPING.
- WHEN NECESSARY, EXISTING STRIPING SHALL BE REMOVED BY HYDROBLASTING UNLESS SPECIFIED BY THE BROOKHAVEN TRAFFIC ENGINEER.
- ALL FINAL SIGNAGE MUST BE INSTALLED CONCURRENTLY WITH THE PERFORMANCE OF THE STRIPING WORK.
- CONTACT THE BROOKHAVEN TRAFFIC ENGINEER ONE WEEK PRIOR TO COMMENCEMENT OF ANY STRIPING WORK.
- A CITY OF BROOKHAVEN UTILITY PERMIT IS REQUIRED FOR ANY CONSTRUCTION WITHIN THE ROW. REFER TO THE CITY'S UTILITY PERMIT POLICY FOR REQUIREMENTS.
- CONTRACTOR IS RESPONSIBLE FOR VERIFICATION OF THE ASBUILT STATUS OF DOWNSTREAM DRAINAGE IMPROVEMENTS PRIOR TO BEGINNING CONSTRUCTION AND SHALL ADVISE THE ENGINEER OF ANY DIFFERENCES NOTED BETWEEN FIELD CONDITIONS AND WHAT IS DEPICTED IN THE CONSTRUCTION DOCUMENTS.
- SAWCUT MUST BE USED IN ANY AREA WHERE NEW PAVEMENT WILL ABUT EXISTING PAVEMENT.
- NO CLOSURES OF OR ENCROACHMENTS INTO THE PEDESTRIAN, BICYCLE, OR VEHICULAR TRAVEL AREAS SHALL BE DONE WITHOUT PRIOR APPROVAL FROM THE BROOKHAVEN TRAFFIC ENGINEER. ALL PROPOSED PLANS FOR CLOSURES AND ENCROACHMENTS SHALL BE SUBMITTED AT LEAST TWO WEEKS PRIOR TO COMMENCEMENT OF WORK.

UTILITY OWNER	SERVICE	CONTACT NUMBERS
ATLANTA GAS LIGHT	GAS	404-548-4796
DEKALB COUNTY WATER	WATER	770-621-7264
DEKALB COUNTY SEWER	SEWER	770-621-7264
AT&T	TELEPHONE	706-701-6081
COMCAST COMMUNICATIONS	CABLE TV	404-597-4353
CROWN CASTLE NG NETWORKS, INC.	FIBER OPTICS	404-409-7533
GOOGLE FIBER	FIBER OPTICS	770-324-7693
GEORGIA POWER	ELECTRIC	404-947-0729

NOTES:

UTILITY DISCLAIMER: EXISTING UTILITY LINES SHOWN ARE BASED ON BEST AVAILABLE INFORMATION AT THE TIME OF SURVEY, WHICH WAS PERFORMED BY OTHERS. CITY OF BROOKHAVEN DOES NOT GUARANTEE THE ACCURACY OF THE LOCATIONS DEPICTED. THE CONTRACTOR SHALL FIELD VERIFY ALL EXISTING UTILITY LINE LOCATIONS PRIOR TO ANY CONSTRUCTION.

CONTRACTOR / INSTALLER SHALL CONTACT 811 PRIOR TO ANY CONSTRUCTION. THE CONTRACTOR SHALL BE RESPONSIBLE FOR ALL UTILITY COORDINATION, ALL COORDINATION WITH ADJACENT PROPERTY OWNERS AND THE REPAIR OF ANY DAMAGED IRRIGATION FACILITIES.



**CITY OF BROOKHAVEN
PUBLIC WORKS DEPARTMENT**

Revision		Date
No		
#1		
#2		
#3		
#4		
#5		
#6		
#7		
#8		
Project No.		
Date		
Scale		1"=30'

**GENERAL NOTES
FOR
BRIARWOOD ROAD MULTI-USE PATH PROJECT
BUFORD HWY TO PEACHTREE CREEK GREENWAY
LOCATED IN
LAND LOT 197, 18TH DISTRICT
CITY OF BROOKHAVEN, DEKALB COUNTY, GEORGIA**

SHEET NO.
2
/ 10

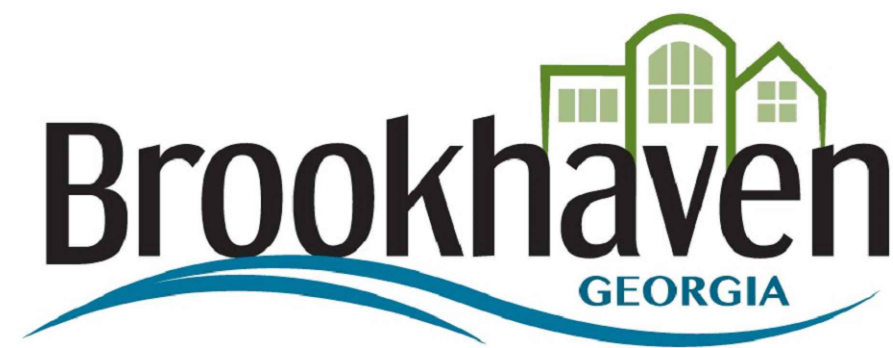

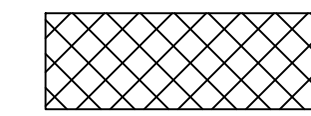

EXISTING SIDEWALK TO BE REMOVED



EXISTING STORM PIPE OR TREE TO BE REMOVED

NOTE: VEGETATION TO BE CLEARED 15' FROM BACK OF CURB ALONG FULL LENGTH OF PROJECT.

GEORGIA WESTZONING MAPS

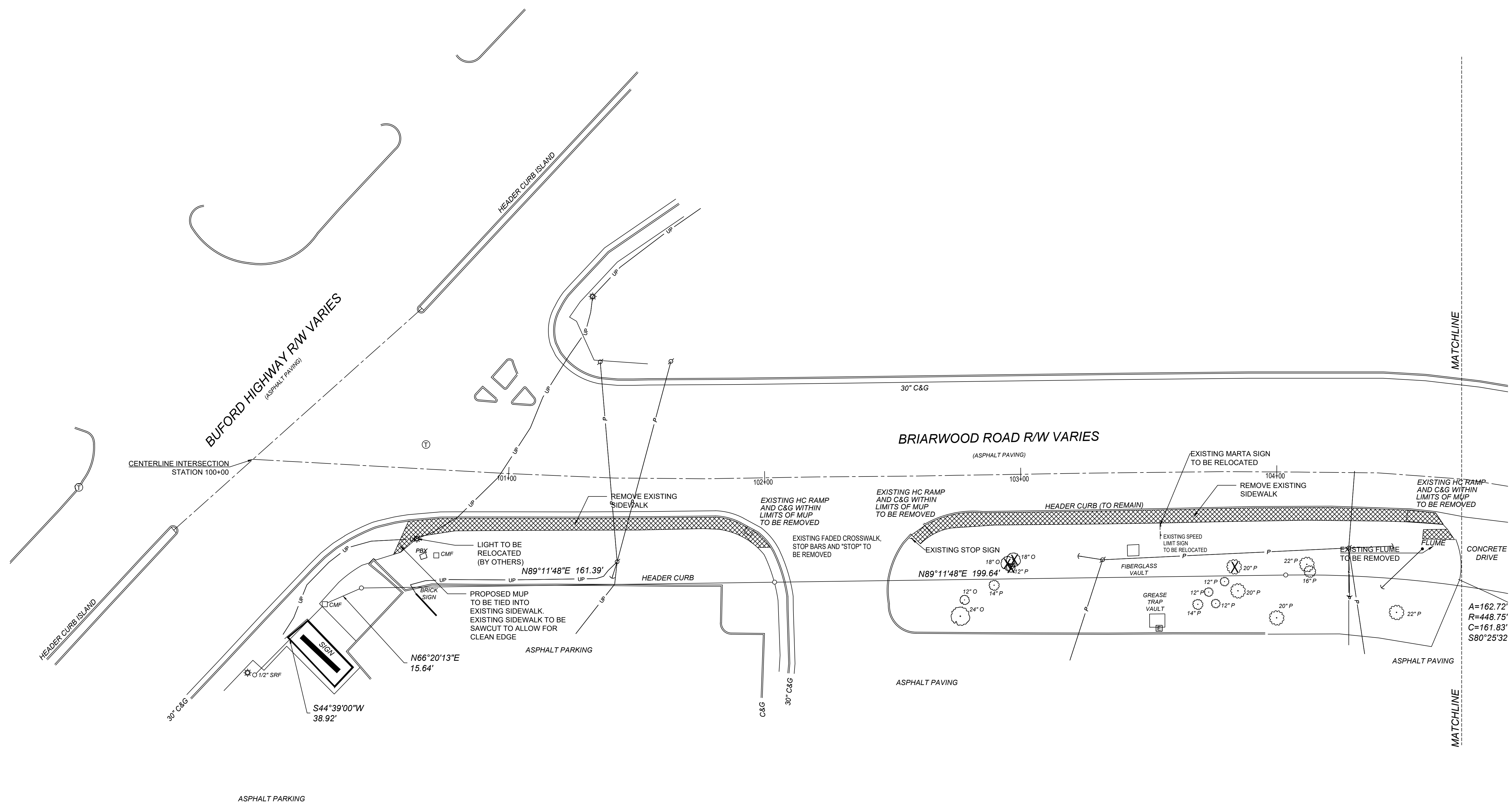

MATCHLINE

MATCHLINE



Contact 811 before you dig.

N/F
CENTRO NP NORTHEAST PLAZA, LLC
DB 23228, PG 726
TP# 18 197 01 041



Revision		Date
No.	By	Date
1		
2		
3		
4		
5		
6		
7		
8		

DEMOLITION PLAN
FOR
BRIARWOOD ROAD MULTI-USE PATH PROJECT
BUFORD HWY TO PEACHTREE CREEK GREENWAY
LOCATED IN
LAND LOT 197, 18TH DISTRICT
CITY OF BROOKHAVEN, DEKALB COUNTY, GEORGIA

SHEET NO.
3 / 10

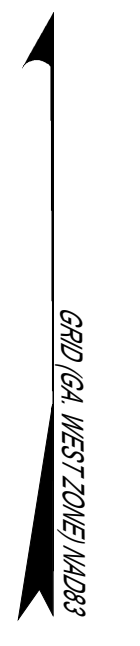
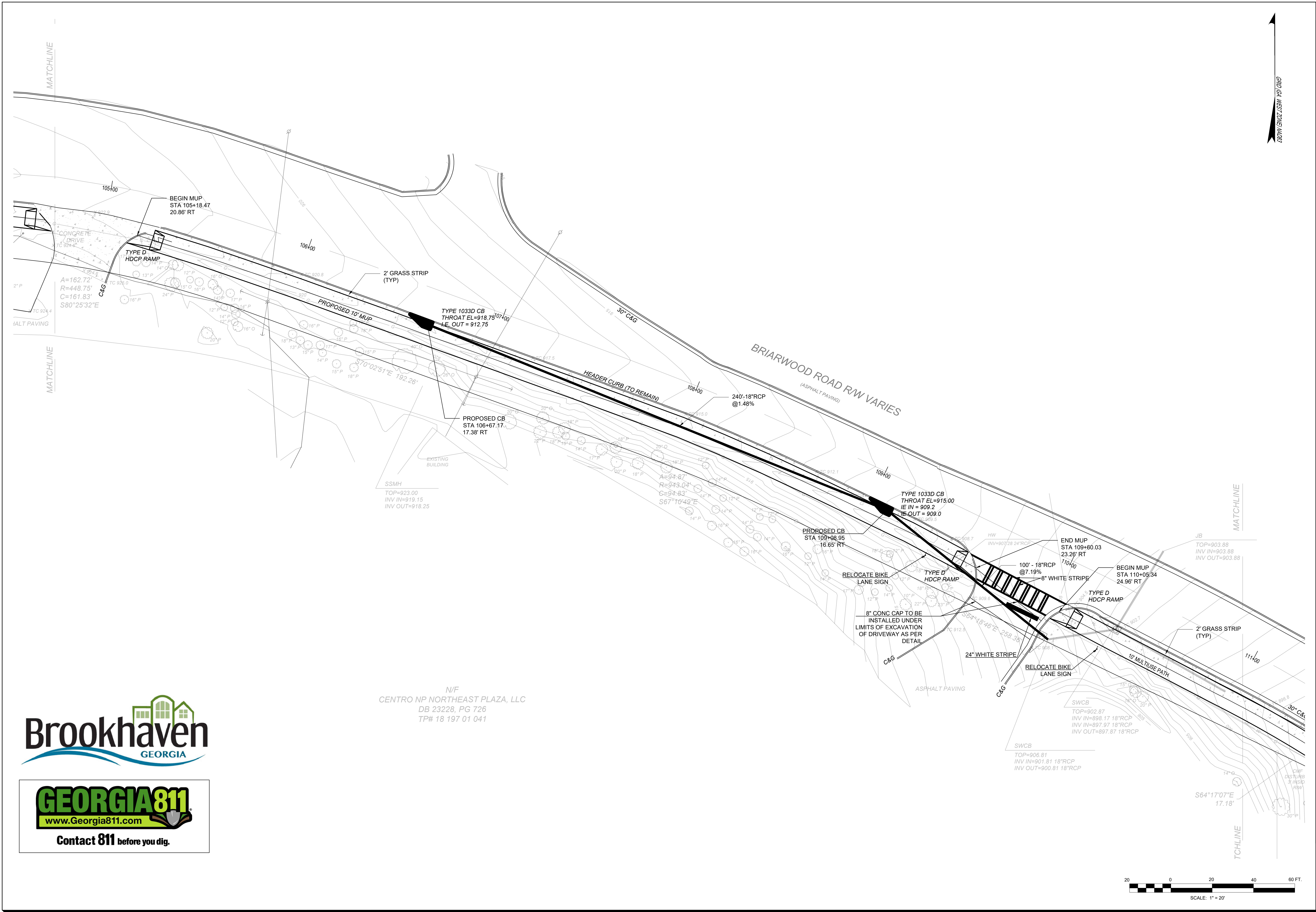

CITY OF BROOKHAVEN
PUBLIC WORKS DEPARTMENT

CITY OF BROOKHAVEN
PUBLIC WORKS DEPARTMENT

Project No.	Revision								Date	Scale
	No.	By	Check	Date	Description	By	Check	Date		

CONSTRUCTION PLANS FOR
BRIARWOOD ROAD MULTIUSE PATH PROJECT
BUJORD HWY TO PEACHTREE CREEK GREENWAY
 LOCATED IN
 LAND LOT 197, 18TH DISTRICT
 CITY OF BROOKHAVEN, DEKALB COUNTY, GEORGIA

SHEET NO.
 7 / 10



GEORGIA811
 www.Georgia811.com
 Contact 811 before you dig.

N/F
 CENTRO NP NORTHEAST PLAZA, LLC
 DB 23228, PG 726
 TP# 18 197 01 041

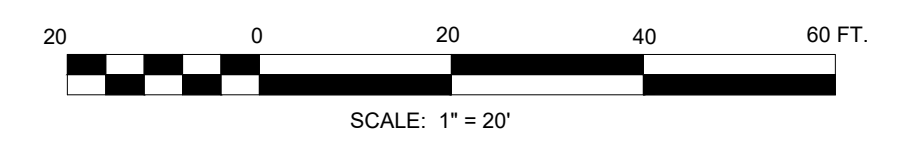

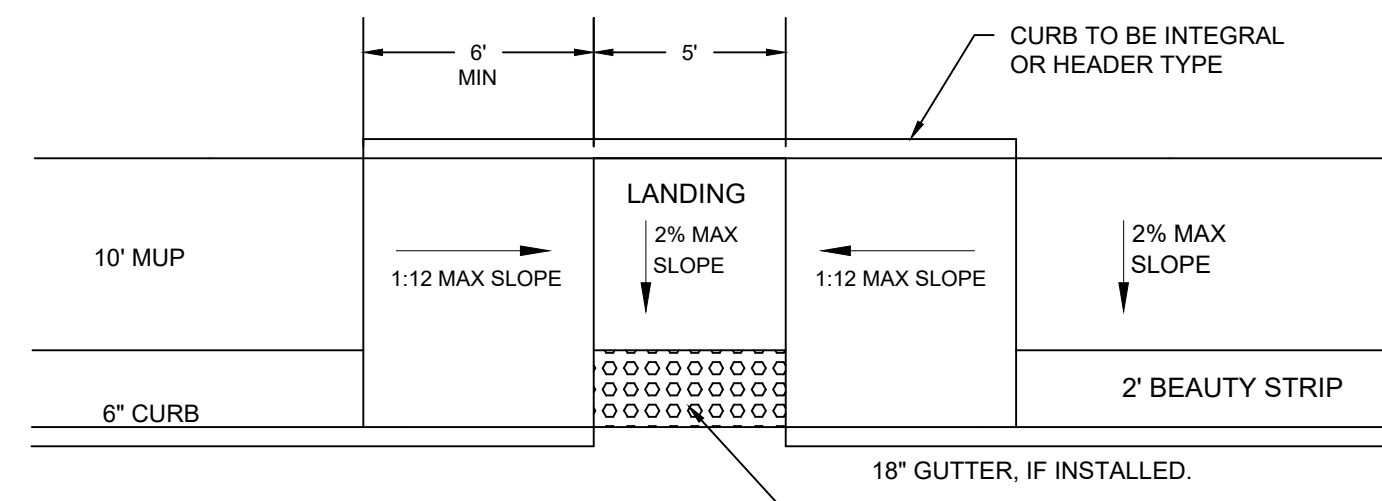

NOTE:
WHERE SIDEWALK ABUTS BACK OF CURB
LANDING AREA MAY BE REDUCED TO 7' MIN
DEPTH BEHIND DETECTABLE WARNING SURFACE.

**HANDICAP RAMP
TYPE "B"**
NOT TO SCALE

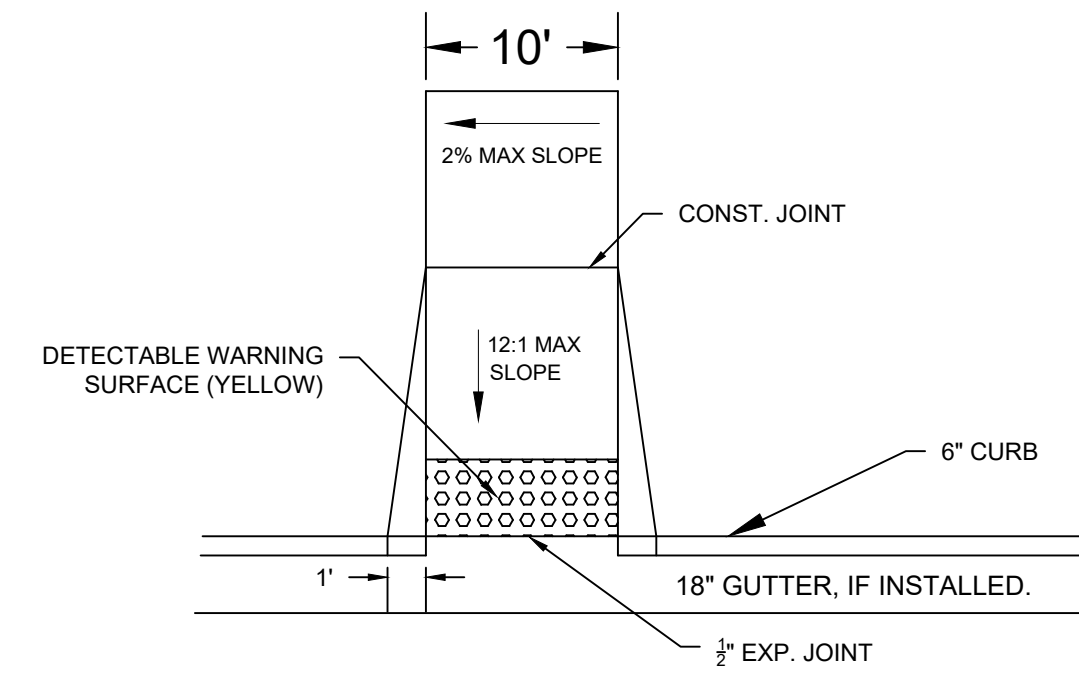

**HANDICAP RAMP
TYPE "D"**
NOT TO SCALE

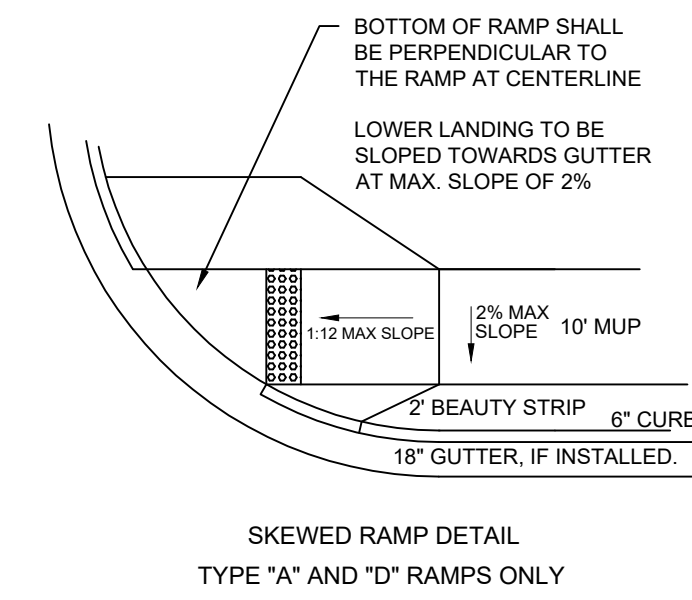

- GENERAL NOTES:
- RAMPS SHALL BE CONSTRUCTED FROM CONCRETE. SPECIFICATIONS FOR RAMPS SHALL BE THE SAME AS FOR SIDEWALK. RAMPS SHALL HAVE EITHER A ROUGH OR TEXTURED FINISH.
 - WHERE RAMPS ARE LOCATED ON RADII, THE DIMENSIONS SHOWN FOR RAMP WIDTHS AND TAPERS ARE MEASURED PERPENDICULAR TO THE RAMP AND NOT ALONG THE CURVE.
 - WHERE UTILITY STRUCTURES CONFLICT, THERE SIDEWALK GEOMETRY VARIES. AT SKEWED INTERSECTIONS, OR IN OTHER SPECIAL CASES, THE RAMP DESIGNS MAY BE MODIFIED BY THE DESIGNER OR ENGINEER, PROVIDED THAT THE WIDTH REMAINS A MIN. OF 48" AND NO SLOPE ON THE ACCESSIBLE PART OF THE RAMP IS STEEPER THAN 12:1.
 - WHEN A CURB RAMP IS PLACED ON EXISTING PAVEMENT, THE PAVEMENT SHALL BE REMOVED TO PROVIDE A MINIMUM THICKNESS OF 3" OF CONCRETE AT ALL LOCATIONS.
 - DETECTABLE WARNING SURFACES ARE REQUIRED ON ALL INTERSECTIONS WITH PUBLIC STREETS, SIGNALIZED COMMERCIAL DRIVEWAYS, AND COMMERCIAL DRIVEWAYS WITH AN AADT OF 25 VPD.
 - REFERENCE SHOULD BE MADE TO GDOT STANDARD A3, SPECIAL DETAIL CONCRETE SIDEWALK DETAILS, CURB CUT (WHEELCHAIR) RAMPS AND GDOT STANDARD A4, SPECIAL DETAIL, DETECTABLE WARNING SURFACE TRUNCATED DOME SIZE, SPACING AND ALIGNMENT REQUIREMENTS.

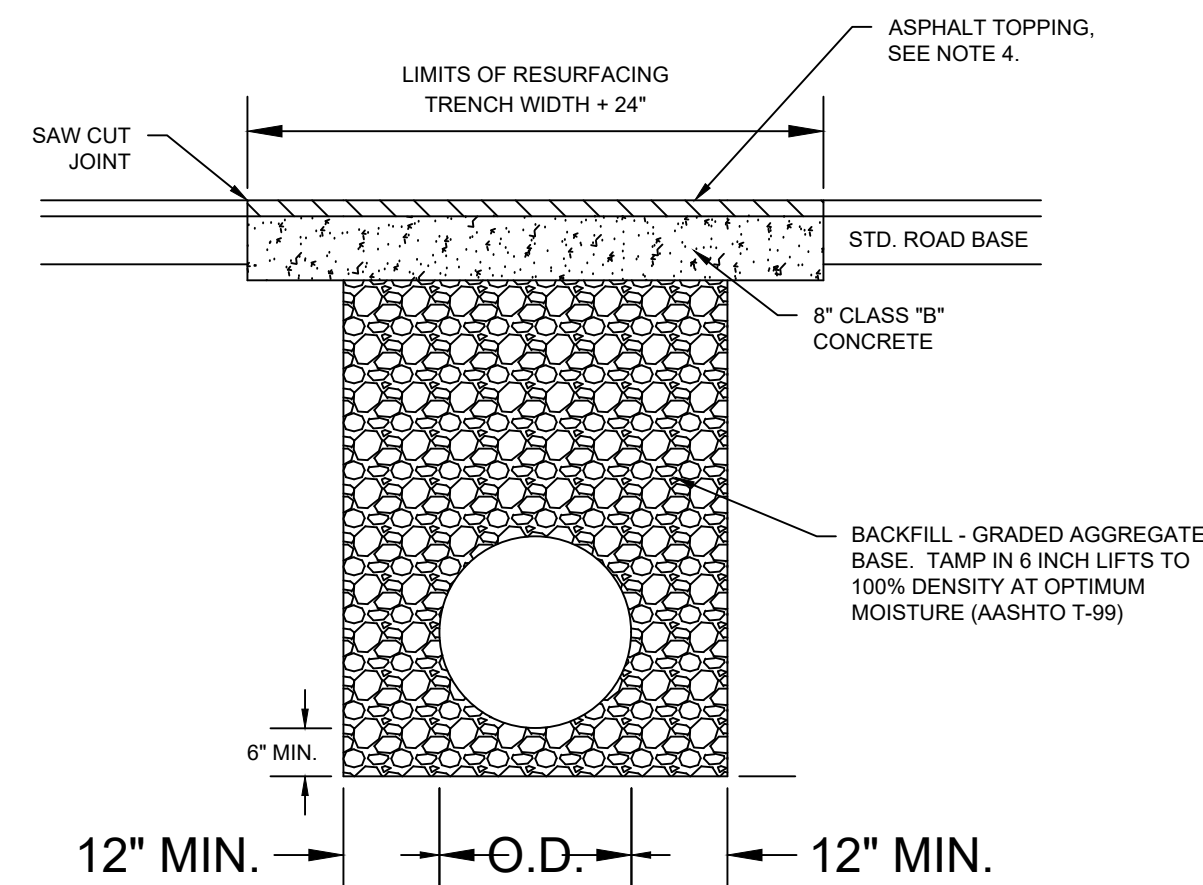

- NOTES:
- ALL STREET CUTS MUST BE COVERED WITH STEEL PLATES OF SUFFICIENT THICKNESS TO SPAN THE CUT WITHOUT NOTICEABLE DEFLECTION. PLATES TO REMAIN IN PLACE UNTIL CONCRETE BASE HAS GAINED SUFFICIENT STRENGTH TO WITHSTAND TRAFFIC LOADS (24 HOUR MIN.). STEEL PLATE TO BE HELD IN PLACE WITH TEMPORARY ASPHALT WHEN TRENCH CUT IS LOCATED ON STREETS WITH A SLOPE GREATER THAN 4% OR IN AREAS OF HIGH TRAFFIC VOLUME.
 - ON LONGITUDINAL CUTS EXCEEDING 50 FEET IN LENGTH AND AT THE DIRECTION OF THE CITY, THE ENTIRE WIDTH OF THE ROADWAY OR LANE SHALL BE MILLED AND RESURFACED.
 - ON LONGITUDINAL CUTS LESS THAN 50 FEET, IF LIMITS OF RESURFACING AS DEPICTED ON DETAIL LIES WITHIN 2' OF EXISTING EDGE OF PAVEMENT, RESURFACING IS TO BE EXTENDED TO EDGE OF PAVEMENT.
 - ASPHALT SURFACE COAT TO BE AS FOLLOWS:
 - LOCAL STREETS (RESIDENTIAL) - MIN. 1-1/2" 9.5 MM SUPERPAVE TOPPING.
 - COLLECTOR AND GREATER (COMMERCIAL/INDUSTRIAL) STREETS - MIN 1-1/2" 12.5 MM SUPERPAVE TOPPING.

**TRENCH EXCAVATION
IN STREET**
NOT TO SCALE



**CITY OF BROOKHAVEN
PUBLIC WORKS DEPARTMENT**

Project No.	Date
Revised	
#1	
#2	
#3	
#4	
#5	
#6	
#7	
#8	
Scale:	1"=20'

**DETAIL SHEET
FOR
BRIARWOOD ROAD MULTIUSE PATH PROJECT
BUFORD HWY TO PEACHTREE CREEK GREENWAY
LOCATED IN
LAND LOT 197, 18TH DISTRICT
CITY OF BROOKHAVEN, DEKALB COUNTY, GEORGIA**



